

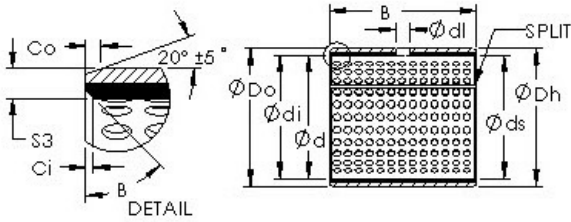

# Tolamentos do Brasil Ltda

## AST AST20 24IB24 plain bearings



Bearing No. AST20 24IB24

Bore Diameter	38,1 mm
Outer Diameter	42,0624 mm
Bearing Type	straight
Shaft Dia., Nominal (d)	1.5000
Shaft Size (ds)	1.4884 / 1.4868
Housing Bore Dia. (Dh)	1.6572 / 1.6562
Bearing Outside Diameter, Nominal(Do)	1.656
Bearing Bore after Mounting (di)	1.4952 / 1.4914
Average Clearance (Cd)	0.0060
Wall Thickness (S3)	0.082
Bearing Length, Nominal (B)	1.500
Bearing Length Tolerance (B tol.) - +.010 / -0.010	+0.010 / 0.010
OD Chamfer Length (Co)	0.045
ID Chamfer Angle (B deg.)	30
ID Chamfer Length (Ci)	0.020
Lube Hole Dia. (dl)	0.313
Material	Carbon steel shell with POM plastic liner

AST20 24IB24 Bearing 2D drawings and 3D CAD models